



## AIR NOZZLE SILVENT 230 W-Z

Item number: 02300170024, 02300270024

SILVENT 220 W-Z - 250 W-Z: The SILVENT 9002W-Z nozzle mounted on a bendable FlexBlow hose. Keeps desired position even at high pressure. Available in 4 different standard lengths. Compressed air is optimally used in this flat nozzle, which through its unique design introduces a completely new blowing technology feature. The aerodynamic nozzle design achieves the effect by maximizing entrainment of air. Each orifice is also uniquely designed to optimize the entrainment area. These small orifices combined with the aerodynamic slots of the nozzle provide high efficiency.

### Technical data

Replace open pipe Ø (mm)	6
Blowing force (N)	5.5
Air consumption (Nm <sup>3</sup> /h)	28
Sound level (dB(A))	78
Nozzle technology	Laval
Material (nozzle)	Zn
Connection	G 1/4"
Connection type	Male
Weight (g)	280
Max temp (°C)	70
Max op. pressure (MPa)	1.0

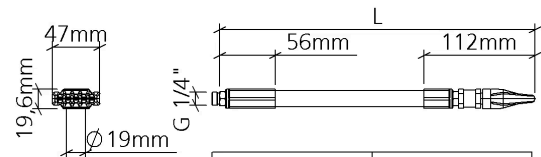

Silvent 220W-Z	L=225mm
Silvent 230W-Z	L=325mm
Silvent 240W-Z	L=425mm
Silvent 250W-Z	L=525mm

### Benefits when replacing an open pipe

Replace open pipe Ø (mm)	6	
Noise reduction [dB(A)]	24 [dB(A)]	81%
Energy savings	39 [Nm <sup>3</sup> /h]	58%

Material specification: Zn ZP0410 EN 12844, NBR 70, CW614N, Cu

### Technical specifications

See basic information about the technical data. [Read more](#)

### Blowing properties at different pressures

Pressure (kPa)	200	400	600	800	1000
Blowing force (N)	2.4	4.6	6.8	8.9	11.1
Air consumption (Nm <sup>3</sup> /h)	13.3	23.2	33.2	43.2	53.1
Sound level (dB(A))	69.9	76.0	79.0	84.1	86.4

### Blowing coverage (mm)

