



## AIR NOZZLE SILVENT 910

Item number: 09100149177, 09100249177

- **Stainless steel rearward blowing nozzle**

SILVENT 910: back-blow nozzle used for blowing clean inside pipes or channels. Cleaning out pipe during and after tooling has always been a problem. Blowing clean using conventional methods is impossible as chips are blown further into the pipe rather than out. SILVENT 910 can handle blow-out of pipe with diameters from 25 mm (1") up to 100 mm (4"). The nozzles are based upon and manufactured in accordance with Silvent's patents, which means that both noise level and air consumption are kept to a minimum.

### Technical data

Replace open pipe Ø (mm)	7
Blowing force (N)	5.5
Air consumption (Nm <sup>3</sup> /h)	38
Sound level (dB(A))	86
Nozzle technology	Hole
Material (nozzle)	1.4305 (303)
Connection	G 1/4"
Connection type	Female
Weight (g)	14
Max temp (°C)	400
Max op. pressure (MPa)	1.0

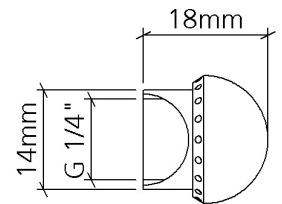
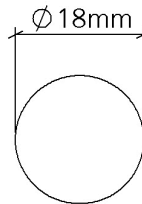

### Benefits when replacing an open pipe

Replace open pipe Ø (mm)	7	
Noise reduction	19 [dB(A)]	73%
Energy savings	54 [Nm <sup>3</sup> /h]	59%

Material specification: EN 1.4305

### Blowing properties at different pressures

Pressure (kPa)	200	400	600	800	1000
Blowing force (N)	2.2	4.3	6.7	8.8	11.0
Air consumption (Nm <sup>3</sup> /h)	15.6	30.0	44.8	59.9	73.3
Sound level (dB(A))	76.5	83.4	87.0	90.1	92.6