



AIR NOZZLE SILVENT 710 TA

Item number: 07100169277, 07100269277

SILVENT 710 TA: adjustable variation of 710. Allows up to 20° blowing angle regulation from the centerline. Same mounting dimensions as 710. Same performance as 710.

Technical data

| | |
|--------------------------------------|--------------|
| Replace open pipe Ø (mm) | 14 |
| Blowing force (N) | 30.0 |
| Air consumption (Nm ³ /h) | 216 |
| Sound level (dB(A)) | 99 |
| Nozzle technology | Slot |
| Material (nozzle) | 1.4305 (303) |
| Connection | G 3/4" |
| Connection type | Female |
| Weight (g) | 275 |
| Max temp (°C) | 400 |
| Max op. pressure (MPa) | 1.0 |

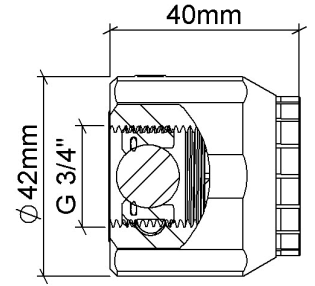
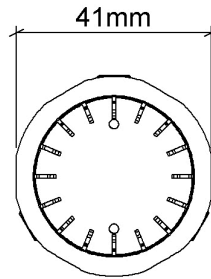

Benefits when replacing an open pipe

| | | |
|--------------------------|--------------------------|-----|
| Replace open pipe Ø (mm) | 14 | |
| Noise reduction | 20 [dB(A)] | 75% |
| Energy savings | 147 [Nm ³ /h] | 41% |

Material specification: EN 1.4305

Blowing properties at different pressures

| Pressure (kPa) | 200 | 400 | 600 | 800 | 1000 |
|--------------------------------------|------|-------|-------|-------|-------|
| Blowing force (N) | 11.8 | 23.6 | 35.0 | 47.3 | 58.3 |
| Air consumption (Nm ³ /h) | 93.0 | 175.0 | 250.0 | 340.1 | 412.0 |
| Sound level (dB(A)) | 91.1 | 96.7 | 100.7 | 103.5 | 105.4 |

Blowing coverage (mm)

