



AIR NOZZLE SILVENT 707 L LP

Item number: 07070169371

SILVENT 707 L LP has a male 1/2" BSP connection thread. Otherwise its performance is similar to the 707 L. Size: $[[\text{HEX}]]23 \times 20 \text{ mm}$ ($[[\text{HEX}]]0.91 \times 0.79 \text{''}$).

Technical data

Replace open pipe \varnothing (inch)	1/2
Blowing force	4.6 lbs
Air consumption (scfm)	70.6
Sound level (dB(A))	94
Nozzle technology	Laval
Material (nozzle)	1.4305 (303)
Connection	G 1/2"
Connection type	Male
Weight (lbs)	0.119
Max temp. (°F)	752
Max op. pressure (psi)	145

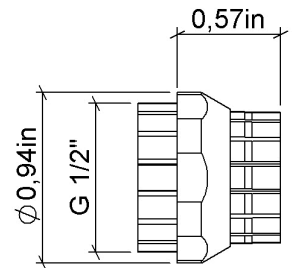
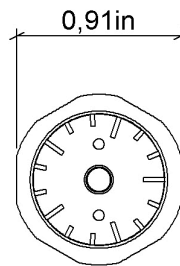

Benefits when replacing an open pipe

Replace open pipe \varnothing (inch)	1/2	
Noise reduction	22 [dB(A)]	78%
Energy savings	85.9 [scfm]	55%

Material specification: EN 1.4305