



AIR NOZZLE SILVENT 220 W

Item number: 02200169393, 02200269393

SILVENT 220 W – 250 W has the nozzle mounted on a bendable FlexBlow hose which remains in the desired position during blowing, even at high pressure. Silvent's FlexBlow hoses are available in 4 different standard lengths. The FlexBlow hose has a male 1/4" connection thread. Otherwise its performance is similar to the 9002W.

Technical data

Replace open pipe \varnothing (mm)	6
Blowing force (N)	6.0
Air consumption (Nm ³ /h)	30.0
Sound level (dB(A))	80
Nozzle technology	Slot
Material (nozzle)	ZYTEL
Connection	G 1/4"
Connection type	Male
Weight (kg)	0.1500
Max temp (°C)	70
Max op. pressure (MPa)	1.0

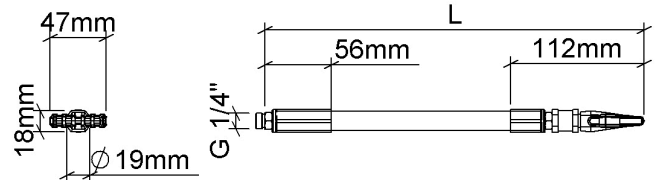

Silvent 220W	L=225mm
Silvent 230W	L=325mm
Silvent 240W	L=425mm
Silvent 250W	L=525mm

Benefits when replacing an open pipe

Replace open pipe \varnothing (mm)	6	
Noise reduction	22 [dB(A)]	78%
Energy savings	37 [Nm ³ /h]	55%

Material specification: Zytel HTN FG52G35 HSL BK011, Desmopan 487, EN 10088-3, NBR 70, CW614N, Cu